



# GROUP PROFILE

“Transforming your desires  
into reality since 1992”

**BLACK COBRA<sup>®</sup>**  
PLY • MICA • WPC

  
**Quantum**  
**UNIVERSITY**  
ROORKEE, INDIA

**ALEX<sup>®</sup>**  
ALUMINUM COMPOSITE PANELS



# OUR DIVERSE RANGE OF PRODUCTS

PVC Laminates



Ply, Board & Flush Doors



Laminates

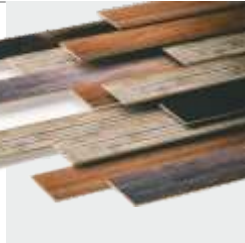

Shapes



Aluminum Composite Panels

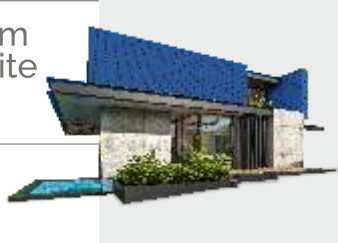

Shuttering Plywood

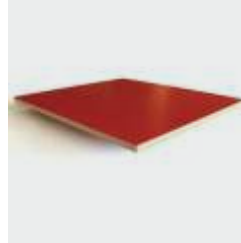

WPC Door and Door Frames



WPC & PVC Boards





# INDEX

About the company	- 01
Mission & Vision	- 02
Group History	- 03
Our Prestigious Clients	- 04
Our presence PAN India	- 05
Certifications and Recognitions	- 06
Product Range	- 07
CSR and Sustainability	- 23



# ABOUT US

It is very gratifying to profile Black Cobra Group before you. It is our way of acknowledging your creativity, taste, eye for quality and sustainability.

Black Cobra Group is a distinguished pillar of the Indian building materials sector since 1992. It manufactures high-quality plywood under the brand name Black Cobra, which is among the top 10 plywood brands in the country. The Group has over 1 million square feet of manufacturing space spread across 6 manufacturing plants.

The group also manufactures Aluminium Composite Panels under the brand name of “Alex Panels”, which is among the pioneers of the ACP industry in India and among the top 5 ACP brands in the country. The products of the group are trusted by leading institutions in India such as ITC, DLF, Supertech, Delhi Metro Rail Corporation, Indian Oil, LIC, SBI, HDFC, LG, Patanjali, Volkswagen, PWD, Samsung, Airports Authority of India, MMRDA, IGL, Shapoorji Pallonji, & more.

Apart from manufacturing a diverse range of building materials (such as plywood, shuttering, flush doors, laminates, PVC boards, ACP, etc), the Group has also etched its mark in the Education sector with a resplendent chain of institutions called Quantum University in Roorkee which is ranked among the top 60 B-schools in India by the Times Group.



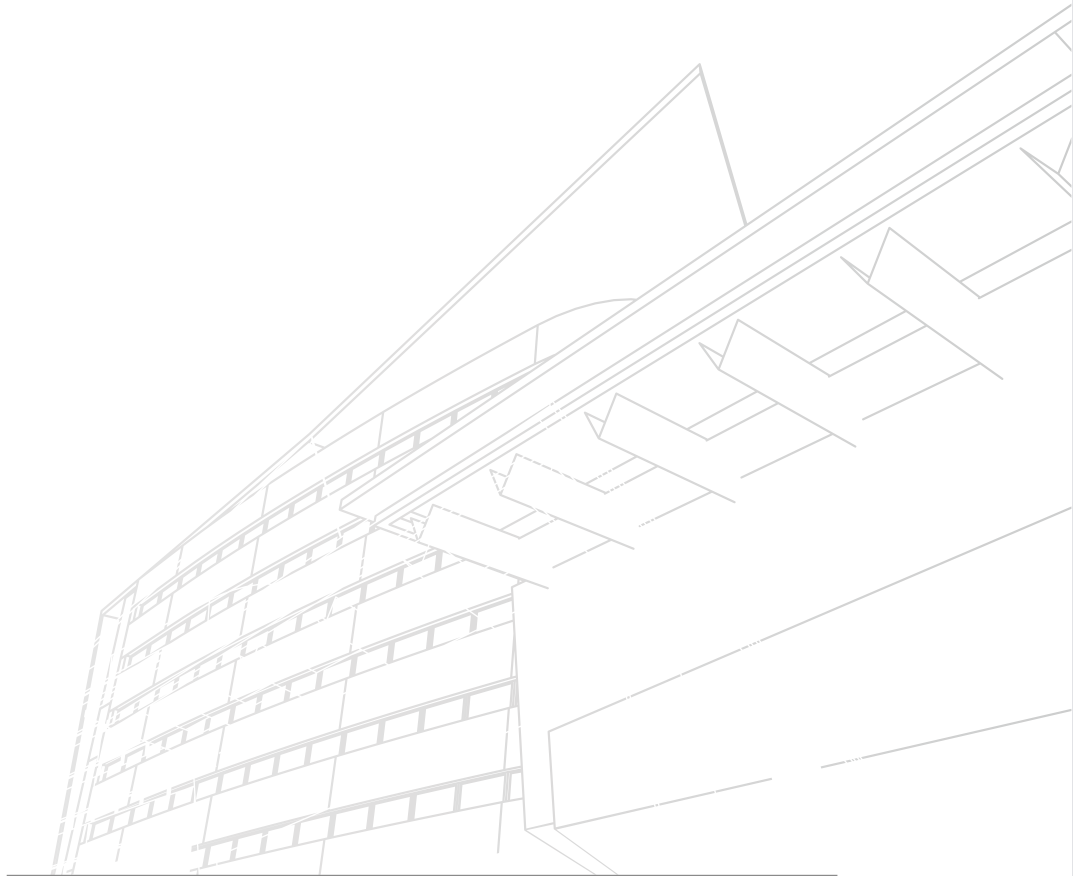

## **Vision**

We aspire to be at the forefront of innovation and sustainability in the building materials industry and provide cutting edge solutions in diversified fields, thus building long lasting bonds with our clients and walk the path of attaining stupendous heights of success together.

## **Mission**

Creating a beautiful future is in our hands and is also one of our major responsibilities to give the best to the future generation. With this aspect in mind, we manufacture high quality, sustainable and economical building materials, all under one roof to enable professionals and experts to convert their ideas into beautiful and sustainable buildings, building a nation of dreams and versatility.

# GROUP HISTORY

- 
- 01 1992 Entered the market with Plywood range
  - 02 1998 Expanded to a range of Doors
  - 03 2005 Launched Alex Aluminium composite Panels
  - 04 2008 Established Quantum University in Roorkee
  - 05 2016 Started manufacturing WPC
  - 06 2017 PVC Laminates and WPC Door Frame
  - 07 2018 Incorporated Laminates in our range
  - 08 2020 Fire Retardant ACP range introduced

# OUR PRESTIGIOUS CLIENTS

We have been serving quality building materials to some of the most respected names in the industry since 1998.



# PAN INDIA PRESENCE

Black Cobra has successfully spread its wings to every corner of the country and to countries outside of India as well. With over 10+ company operated godowns, 50+ renowned distributors and 2000+ Dealers and channel partners throughout India, Black Cobra has truly established itself as a Pan Indian brand.



# CERTIFICATIONS AND RECOGNITIONS

As a mark of our standard of quality, which are maintained throughout, Black Cobra group has been recognized and awarded by several institutions for its above par quality of its various products.



CM/L-7200060997



प्रोड - perform - प्रैक्टिस - Plastics



CBRI



## PRODUCT RANGE



# COMMERCIAL PLYWOOD

Veneers from high-quality logs are mechanically dried and they undergo a stress-relieving process, which are assembled in such a way to form a balanced construction. High quality fortified synthetic resins are used for gluing the veneers. The glue line is poisoned by special formulations of chemicals to make Black Cobra Plywood safe against borers. It is hot pressed under proper temperature and more than 16 kg/cm<sup>2</sup> specific pressure. Conditioning is done after pressing followed by preservative treatment.

Applications: Living room, study room, offices, wall paneling, partitioning.

# MARINE PLYWOOD

Black Cobra Marine Plywood is the outcome of a perfect amalgamation of excellent quality raw inputs, advanced technology, and expertise of our diligent team. While manufacturing the Marine Grade Plywood, we make sure that all the stages such as gluing, cold pressing, hot pressing, sanding are carried out under the instructions of experts. The finished plywood is examined for ideal dimensions, visual imperfections, and quality finish before stamping it with Black Cobra hallmark.

Applications: Outdoor furniture in gardens, decks, porches.



Extra Layer  
Extra Strength



Moisture  
Resistant



Kills 99.99%  
viruses



Glue Line  
Protection



Tested as per  
global standards



Low Toxic  
Emissions



25 year  
warranty



Carpenter  
Friendly



Made from Eco  
Friendly Timber

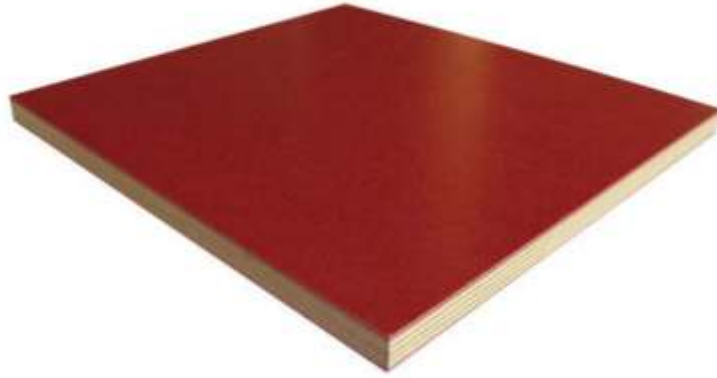

# SHUTTERING PLYWOOD

This plywood range is manufactured from superior quality wood, procured from the most reliable vendors in the industry. The offered Resin Coated Shuttering Plywood is thoroughly quality tested after the production is completed. Our team of expert quality inspectors conducts the tests by employing requisite evaluation tools and equipment. They ensure that the entire range is durable, tough and environment friendly.

Applications: Factories and buildings, construction of sewer, swimming pools, bridges, exterior, and general shuttering work, beams, building construction and foundation job.

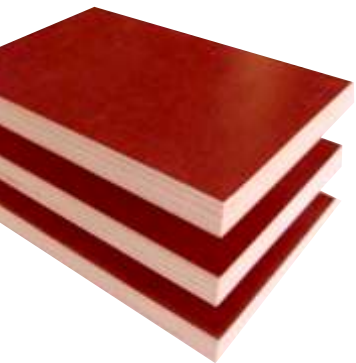

Extra Repetitions



Superior Strength



100% Boiling Water Proof



Made from Eco Friendly Timber

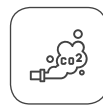

Low Toxic Emissions



Tested as per global standards

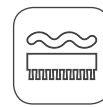

Abrasion Resistant



Weather Proof

# CALIBRATED PLYWOOD

Plywood that has gone through a process called calibration is known as Calibrated Plywood. Calibration is a process from which uniform thickness and smooth surface of plywood are achieved. It helps in the uniform application of adhesive, in turn improving the strength and life of the plywood.

Applications: OEMs, Indoor furniture, Kitchen cabinets, Table tops and other areas where large stained wood surfaces are needed.



100% thickness  
uniformity



100%  
Dimensionally  
Stable



Moisture  
Resistant



Glue Line  
Protection



Made from Eco  
Friendly Timber



Tested as per  
global standards





# FLUSH DOORS

Black Cobra Flush Doors are stylish, durable, environment friendly and nominally priced, which make them one of the most sought after products among our global clients. Our quality management schemes begin as soon as we acquire the raw inputs from our vendors. These inputs are used in the manufacturing stages only after their superior properties are conformed by our quality testers. The expert quality inspectors hired by our organization not only supervise the production stages, they also test the finished output to confirm that the Decorative Flush Doors are devoid of any manufacturing flaws.

Applications: Door shutters in homes and offices.



100% Boiling Water Proof



Superior Strength



Glue Line Protection



Low Toxic Emissions



Tested as per global standards



Kills 99.99% viruses



Made from Eco Friendly Timber



25 year warranty



Carpenter Friendly



# LAMINATES

1mm and 0.8mm

Black Cobra's decorative laminate ranges consist of two collections – 1 mm & 0.8 mm. This stunning range of high-pressure laminates is home to numerous designs and finishes.

Applications: Countertops for kitchens/science labs, school furniture, office furniture, healthcare, retail, commercial interiors as well as many industrial applications.



Full Thickness



100% PF Glue



Glue Line Protection



Scratch Resistant



Anti Microbial



Impact Resistant

# OTHER OFFERINGS

Blockboard



Decorative Plywood

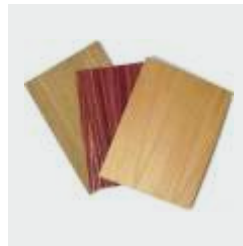

Aluminium Cladded Plywood



Flexi Plywood



Membrane Doors

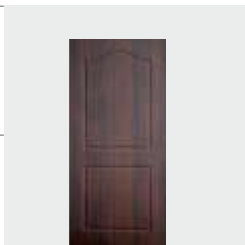

Compreg Plywood



Chequered Plywood

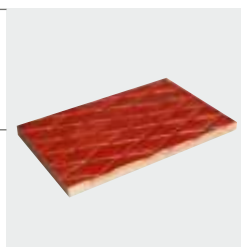



# ACP

Alex Panels are high-grade ACPs (Aluminum Composite Panels), which are majorly used on exterior walls and facades of buildings. ACPs are also sometimes known as sandwich panels. These are made with a composite material in which thermoplastic polythene core and fire-retardant core material are sandwiched between two color coated aluminum sheets.

At Alex Panels, we keep innovating and improving the product in our Research & Development wing. Working on global standards, we keep an eye on International development in the ACP sector and offer the best to our clients. Alex Panels are available in a wide range of collections, color shades and textures to give a trendy and stylish look to your buildings and structures and suit your vivid imaginations.



# ACP

## Features

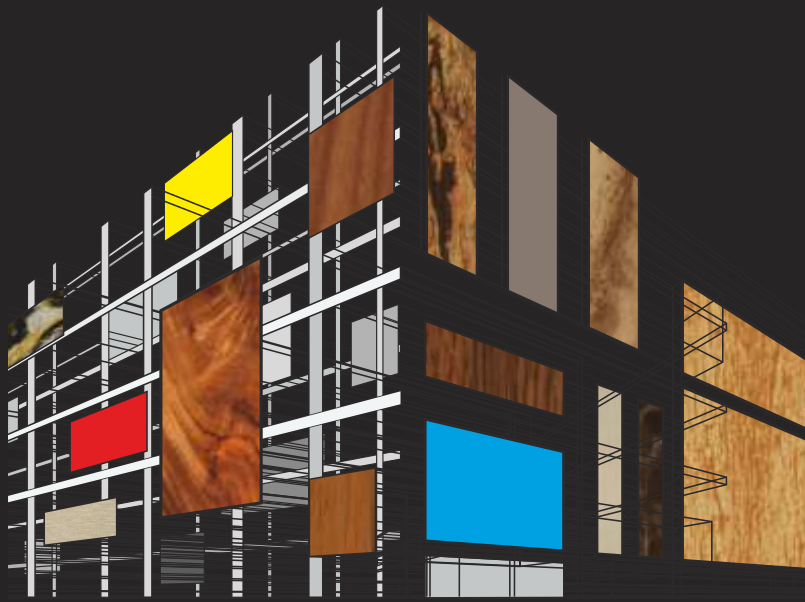

- Anti-fungal protection
- Lightweight – reduces frame loading and installation costs
- Capable of being shaped and formed without loss of surface integrity
- High strength and rigidity – outstanding deflection capacity and bending strength
- Short time for mounting, as a result it cuts down construction time
- Good sound insulation and low resonance factor – reduces unwanted vibrational noise
- Ease of installation and fabrication – can be cut, drilled, punched and stamped
- Resistance to extremes of weather exposure and temperature
- Excellent UV characteristics – Retains color after long exposure
- Smooth paint finish and lacquering – three layer PVDF 70% Kynar-500
- Superior flatness – ideal for creating smooth, monolithic surfaces
- High impact resistance
- Very low coefficient of expansion



# ACP

## FR Range

From the lap of luxury and straight to your classy dwellings, Alex presents a fantastic collection of Fire Retardant ACPs. For added safety, this range stops the spread of fire under any condition and works as a fire safety blanket that is immaculately paired with features of modern ACP.

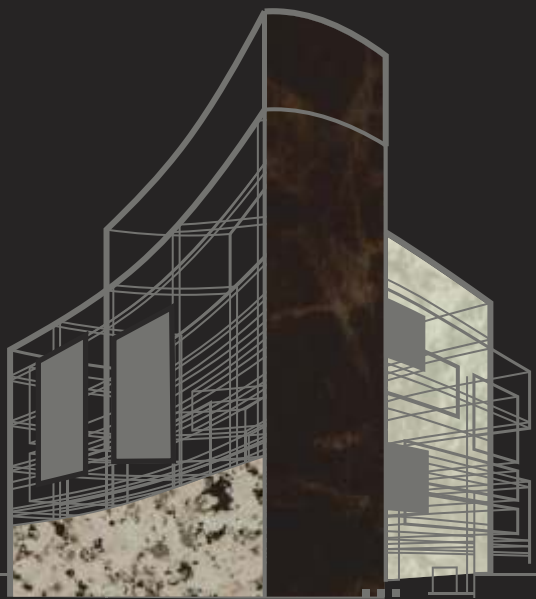
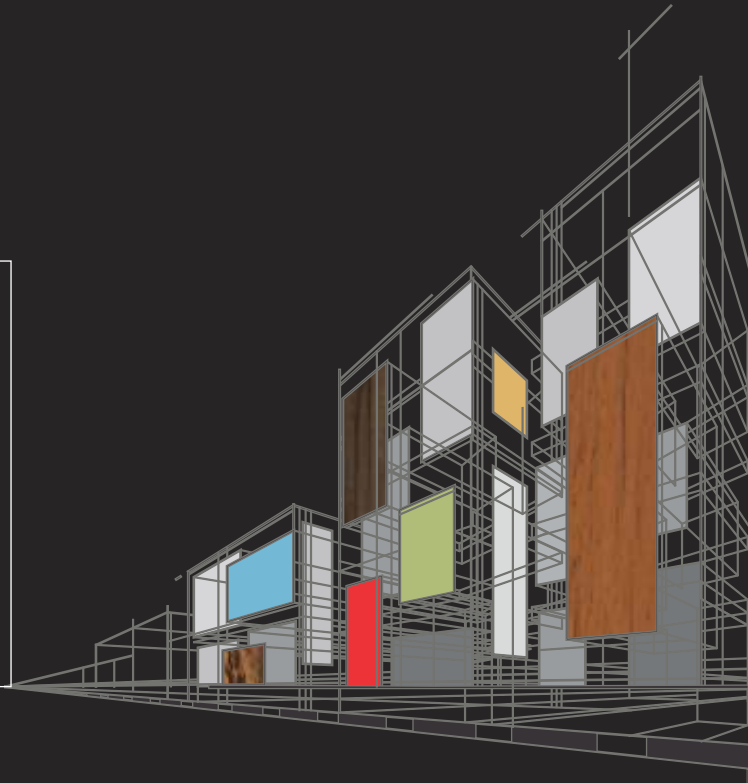

## Marwud

MARWUD RANGE is a premium range introduced by Alex Panels which consists of Wood, Marble, Brick range of colors that enhance the look and feel of your exterior elevation as these can be used mostly in Exteriors of Houses, Farmhouses, Hotels, etc. These panels give the most elegant and glamorous look to your building structure at the same time giving a real wood & stone effect.



**FIRE  
RATED**



**ENVIRONMENT  
FRIENDLY**



**RECYCLABLE  
MATERIAL**



**TERMITE  
PROOF**



**WEATHER  
PROOF**



# ACP

## Partition

Alex Panels has developed this innovative and beautiful collection of partition panels as an added accessory to modern-day décors. Made available in incredible designs and colors, the Alex Partition range fulfills all requirements.



## HPL

Taking advantage of advanced technology that makes High Pressure Laminates possible; Alex Panels is here with its Impression HPL range of extraordinary aluminum composite panels perfect for use in contemporary residential and commercial buildings.



**PVDF**  
COATING



**FIRE**  
RATED



**ENVIRONMENT**  
FRIENDLY



**RECYCLABLE**  
MATERIAL



**TERMITE**  
PROOF



**WEATHER**  
PROOF

# ACP

## Rainbow

Rainbow Range is a color range which includes metallic and solid colors for exterior elevation buildings and offices such as malls, corporate buildings, shop exteriors, signage, etc.



## Impression

The Impression Range of Alex Panels aluminium composite panels consists of modern interior coverings, made available in a whole host of designs for interiors applications.



**PVDF**  
COATING



**FIRE**  
RATED



**ENVIRONMENT**  
FRIENDLY



**RECYCLABLE**  
MATERIAL



**TERMITE**  
PROOF



**WEATHER**  
PROOF



# PLAWOOD

(PVC Board)

"Black Cobra PlaWood" is a high density WPC Board which is the best among other panel products in terms of its features and is known for its durability and thermoplastic properties.

PlaWood boards from Black Cobra are manufactured using virgin plastic and wood fibers, which are highly resistant to extreme weather, moisture, termites and require low maintenance. PlaWood boards won't rot, crack, warp like timber used for interior and furniture making.

PlaWood board is leading the way with its environmental friendly, low maintenance range of thermoplastic composite decking boards.

Applications: Ceilings of car/bus/trains, the interior of building wall panels, commercial/residential/public/office buildings, computer lettering/ screen printing/ advertising, labeling/display panel, and signs industry.

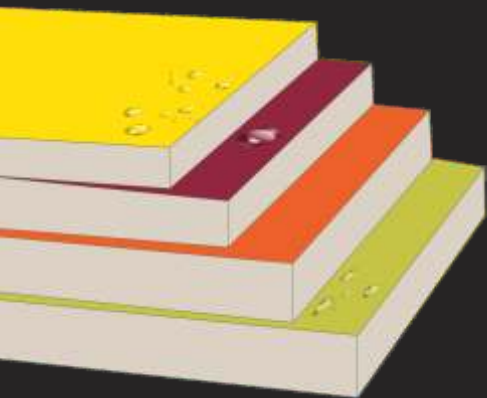

HIGHER LOAD  
BEARING



HIGH SCREW  
HOLDING CAPACITY



101%  
WATER PROOF



ECO-  
FRIENDLY



101%  
TERMITE PROOF



FIRE  
RETARDANT

# CHAUKHAT

Black Cobra Chaukhat are modern door frames made by mechanized manufacturing process, which offers uniform thickness without undulation, warping or bending and a smooth surface for laminations. It offers dimensional accuracy and stability in varying humidity and has a high screw holding capacity, high shock and buckling resistance.

100% termite and borer proof, moisture proof, fire retardant and most importantly an eco-friendly product. Black Cobra Chaukhat stands for superb quality, down and through the production line.

INDIA'S HIGHEST QUALITY WPC

DOOR  
FRAME



MADE USING INDIA'S 1ST 72 HRS COLD WATER CURING PROCESS FOR ENSURING LIFE LONG DURABILITY.



HIGHER LOAD  
BEARING



HIGH SCREW  
HOLDING CAPACITY



101%  
WATER PROOF



ECO-  
FRIENDLY



101%  
TERMITE PROOF



72 HOUR  
WATER TREATMENT



FIRE  
RETARDANT



READY TO PAINT & POLISH  
IN ANY COLOR YOU WANT



# DARWAZA

Black Cobra Darwaza is a range of high density WPC Doors. The Black Cobra Darwaza range is known for its durability, attractive designs and best-in-category features. A better alternative than wooden doors and other products, Black Cobra Darwaza combines the best qualities and contemporary aesthetics to deliver a superlative experience in your entryways.

These WPC Doors from Black Cobra are manufactured using virgin plastic and wood fibers, which are highly resistant to extreme weather, moisture, termites and require low maintenance. In addition, Black Cobra Darwaza won't rot, crack, warp like natural wood commonly used to make doors.

Black Cobra Darwaza is leading the way with its environment friendly, low maintenance range of thermoplastic composite decking boards. It is conserving our precious forest timber and contributing positively to reducing global warming and habitat degradation.

Applications: Windows, doors, outdoor or indoor cladding, door and windows frames, decking, railings, fences.



HIGHER LOAD  
BEARING



HIGH SCREW  
HOLDING CAPACITY



101%  
WATER PROOF



ECO-  
FRIENDLY



101%  
TERMITE PROOF



FIRE  
RETARDANT



READY TO PAINT & POLISH  
IN ANY COLOR YOU WANT

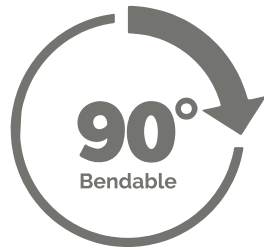

Black Cobra PVC Laminate

# PVC LAMINATES

Made from natural substances and apart from being waterproof, moisture-proof, fire-retardant, and termite-proof, Black Cobra's PVC Laminates also beautify your place.

Applications: Interiors and exteriors of commercial and residential projects.



90 degree bendable



Aesthetic Finish



101% Water Proof



101% Termite Proof



Fire Retardant



Eco Friendly

# SHAPES

Transform your interiors and exteriors with the stunning range of decorative 3D wall panels and grills. All our designs are uniquely crafted with inspiration drawn from nature.

Black Cobra Shapes deliver true texture to your walls, bar fronts, reception counters and any vertical surface, making them come alive.

Black Cobra Shapes are made from high quality virgin PVC mixed with environmentally friendly compounds that ensure that they have high strength and are Waterproof, Fire Retardant, Weatherproof and Termite Proof, which gives them a long life.

Applications: Walls and ceilings of offices, high-rise residential, restaurants, bars.



Aesthetic  
Finish



101%  
Water Proof



101%  
Termite Proof



Fire  
Retardant



Eco  
Friendly



High  
Density



Ready to Paint & Polish  
In Color You Want

# CSR AND SUSTAINABILITY

QUANTUM UNIVERSITY



The Black Cobra Group decided to broaden its horizons and give back to the society by improving the standards of education, which it did by opening its university in Uttarakhand's Roorkee – Quantum University. It is ranked among the top 20 B-schools in North India and among the top 60 B-schools in India by the Times Group.

The perfect amalgamation of high-quality education and innovative teaching practices has made Quantum University Roorkee, the best university of engineering and technology in the region. While expanding the horizons of higher education in India, Quantum University has successfully established itself as a well-known holistic education provider, not only in Uttarakhand but in entire India. The university is approved by UGC and takes huge pride in its unique aspects such as interdisciplinary pedagogy, updated and future-ready curriculum, Passion Programs (PROPS) and much more. At Quantum, the way education is imparted to students, not only expands their knowledge base but also develops problem-solving abilities, effective communication skills and interpersonal skills in them. The university focuses on the overall development of the students and imbibes positive competitive abilities in them so that they become lifelong learners and contribute to national development.

## OTHER INITIATIVES

Black Cobra Group strives every day to focus on new issues and help out the society in every which way possible. With the help of our employees and associates, we have been making a difference in people's lives and putting a smile on their faces.

Under our CSR initiatives, we have carried out several food and clothing donation drives to help the people in need. In addition, we have also embraced the importance of education for girls and women in our society. To pledge our support towards educating girls, we also regularly sponsor the education of several girls.





# GREEN INITIATIVE GO GREEN

We as a company believe that we must do our part to produce a product which minimizes the impact on Mother Nature. By taking this responsibility, our next generation can inherit a world in which they can have better future.

Black Cobra continuously strives to improve its operations and production process to reduce its carbon footprint.

We do this by:

- Choosing to deal with raw material suppliers who are certified and accredited with environment friendly practices
- Choosing to deal with raw material suppliers who are located within a 500 miles radius of our factory, so as to reduce the emissions of CO<sub>2</sub>, from transportation, which deliver the raw materials to us
- Embracing manufacturing processes that do not emit any green house gases
- Using more than 50% renewable energy (such as solar energy) to power our manufacturing plants
- Recycling all our waste production using environmentally friendly practices
- Recycling the LDPE resins by selling them to special recycling facilitates
- Recycling of waste water
- Installing a regenerative catalytic thermal oxidizer on our paint coating lines to reduce the release of Volatile Organic Compounds (VOC) during the paint coating process
- Using energy saver bulbs to light all areas of our manufacturing facility and administrative buildings
- Using raw materials which are biodegradable and non-toxic

These may be just some small steps which we have consciously decided to embrace and we will always strive to implement more ways to reduce our impact on the world's fragile environment. We are certified by IGBC and meet their criteria so as to be classified as a 'Green Building Material'. Our products proudly contribute to LEED points for buildings to be sustainable and environmental friendly.

## MANUFACTURING UNITS

- **ALEXIA PANEL**  
999, Central Hopetown, Jamanpur Road, Selaqui Industrial Area, (SELAQUI), Dehradun - 248 011  
PH: 0135 2699 153  
Fax: 0135 2699 156
- **YAMUNA INTERIORS PVT. LTD.**  
Plot No. 26-28, Industrial Estate, Manakpur, Jagadhri, Dist. Yamuna Nagar - 135 001, Haryana  
PH: 96818 22222
- **PUNJAB PLYWOOD INDUSTRIES, SANGRUR**  
Gaushalla Road, Railway Chowk, Sangrur - 148 001, Punjab  
PH: 97812 12222
- **PUNJAB PLYWOOD INDUSTRIES**  
Kami Majra, Khajuri Road, Yamuna Nagar - 135 001, Haryana  
PH: 93555 04111
- **PUNJAB WOOD PRODUCTS**  
Plot No. 24, Mehmoodpur, Salempur Road, Chhachhrauli, Yamuna Nagar - 135 103  
PH: 93555 04111
- **BLACK COBRA LAM PVT. LTD.**  
Plot No. 24, Mehmoodpur, Salempur Road, Chhachhrauli, Yamuna Nagar - 135 103  
PH: 93555 04111

## DOMESTIC BRANCHES/OFFICES

### JAIPUR

P. NO. 04, Kirti Sagar, Block H, Mangayawas, Mansarovar, Tehsil- Sanganer, Jaipur (RJ) - 302 020  
PH: 76175 99022

### PANCHKULA

Plot no. 149, Phase - 2, Industrial Area, Urban Estate, Panchkula (HR) - 134 113  
PH: 85588 04926, 85588 49579

### JAMMU & KASHMIR

Aknoor Road, Lower Barnai, Jammu - 181 205  
PH: 94192 04472

### RAIPUR

01, Ramsagar Para, Punjab Oil Mill Lane, Bhaisthan Road, Dist. Raipur, Chattisgarh - 492 001  
PH: 95840 04488

### HYDERABAD

# 13-1-17/1/2, Mangalhat, Hyderabad, Telangana - 500 012  
PH: 92461 99015

### BENGALURU

250/450/11, Deepanjli Nagar Mysore Road, P.P. Industrial Area, Next to Vasco Woods, Bengaluru (Bangalore) Urban, Karnataka - 560 039  
PH: 89700 80000, 98450 15817  
PH (ACP): 99729 30606, 95626 30000

### NAGPUR

Lajwanti Complex, 10/2 Central Avenue, Near Gandhi Putla Sq., Nagpur - 440 002  
PH: 94231 02728

### DELHI

B-76, Okhla Industrial Area, Phase - 2, New Delhi - 110 020  
PH: 76175 99003, 95489 01114

### INDORE

Survey No. 140/1/1, By Pass, Rala Mandal Square, Indore (M.P.) - 452 020  
PH: 94253 17952

### BHUBANESWAR

Khumaltar - 40/41, Mancheswar Industrial Estate, Bhubaneswar, Odisha - 751010  
PH: 98610 54507

### AHMEDABAD

C-101, Sagar Estate, Near Sukh Sagar Hotel, Between Ujala Circle & Sanand, Ahmedabad - 382 210  
PH: 93270 38175

### KERALA

21/569, Fathima Arcade, Seaport Airport Road, HMT Colony, PO Kalamassery, Ernakulam, Kerala - 683 503  
PH: 98460 02526

### DELHI

S-33, Phase - 2, Okhla Industrial Area, New Delhi - 110 020  
PH: 99909 10950

### GUWAHATI

Near Navajagran Club, A.K. Dev Road, Dhirenpara, Guwahati, Assam - 781 025  
PH: 99574 37994

### NEPAL

Khumaltar - 14, Lalitpur, Nepal - 284 403  
PH: +977 98510 59887